

## MDI 18/8 M2 0,55kW (300716900)

### GENERAL DATA



#### MEDIUM PRESSURE FAN WITH FORWARD IMPELLER AND IN STAINLESS STEEL CONSTRUCTION

##### MANUFACTURING FEATURES:

- Welded stainless steel AISI 304 housing.
- Stainless steel simple inlet forward curved impeller.
- Standard asynchronous squirrel-cage motor with IP-55 protection and Class F insulation. Manufactured with standard voltages: 230V 50Hz for single phase motors, 230/400V 50Hz for three phase motors.
- Available positions (to be indicated in case of order): LG270, LG0, LG45, LG90, LG135, LG180, LG225, LG315, RD0, RD45, RD90, RD135, RD180, RD225, RD270, RD315.
- The indicated codes correspond to the model in position LG270.

##### APPLICATIONS:

Designed for inline installation, they are suitable for:

- Industrial applications, extraction or injection of air.
- Cooling of machines and parts.
- Clean air transport.
- Corrosive air transport.
- Maximum working temperature: carried air: 130°C, ambient: 1ph 50°C, 3ph 60°C.

##### UNDER REQUEST:

- 60Hz fans and special voltages.
- 2 speed motors (three phase motors).

### PERFORMANCE CURVE

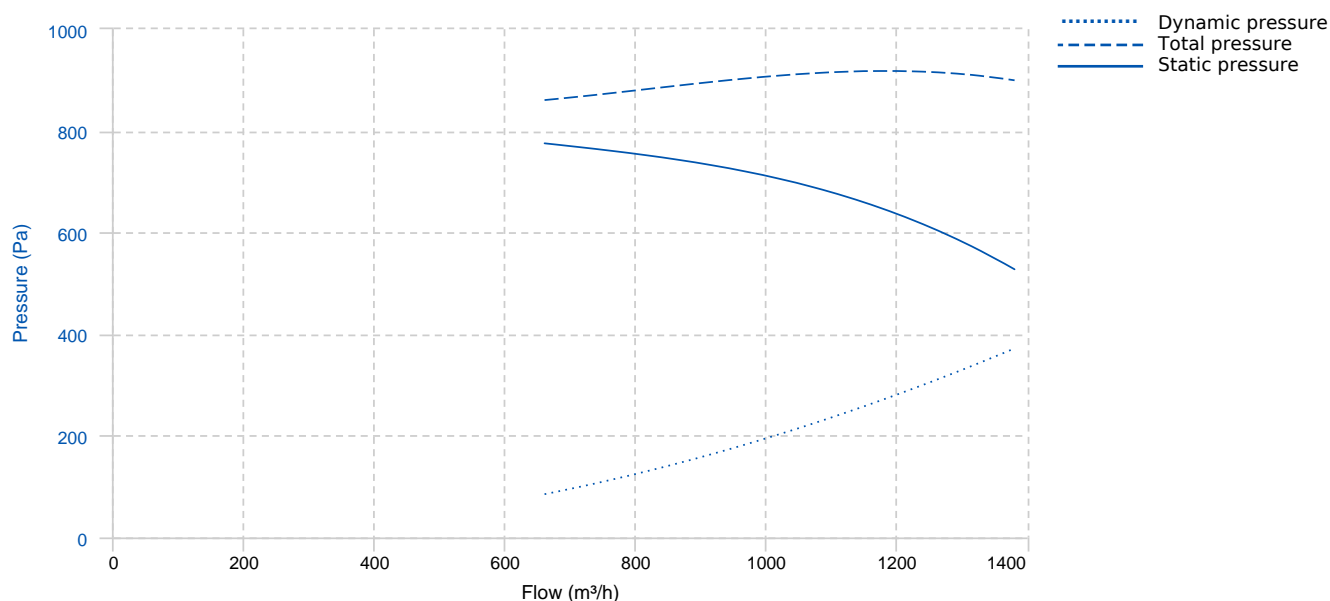

TECHNICAL DATA

Fan							
RPM	2800	Approx. weight	10.2 kg	Max. Flow	1380 m³/h		
Motor							
Power	0,55 kW	RPM	2800	Capacitor	20µF 450V	I max. (230V)	3,71 A
Size	71	Approx. weight	6.7 kg	Efficiency (%)	70 %	FP	0.92

DIMENSIONS

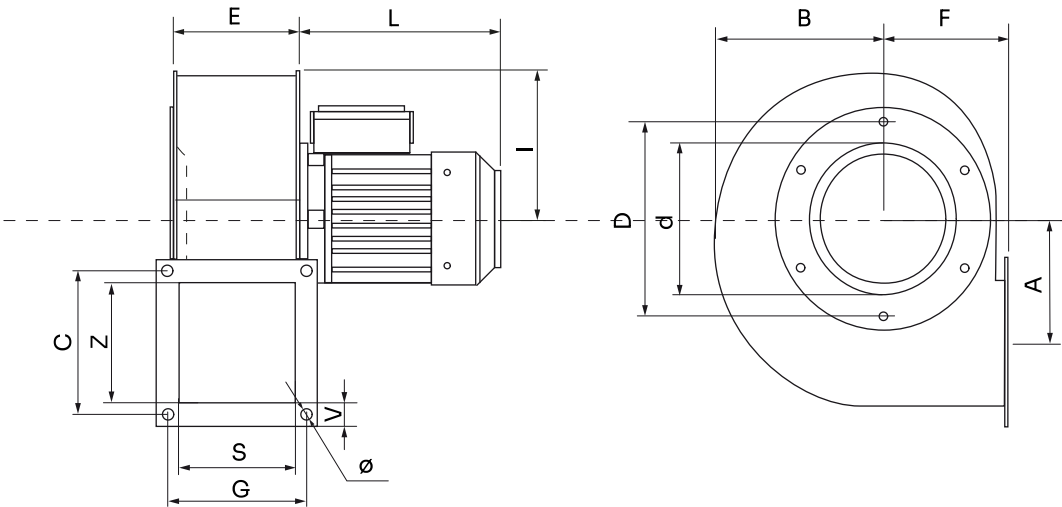

Dimensions (mm)									
A	115	B	158	C	133	D	200	E	114
F	120	G	133	I	134	L	215	S	110
V	22.5	Z	110	d	140	Ø	9x16		

WIRING DIAGRAM

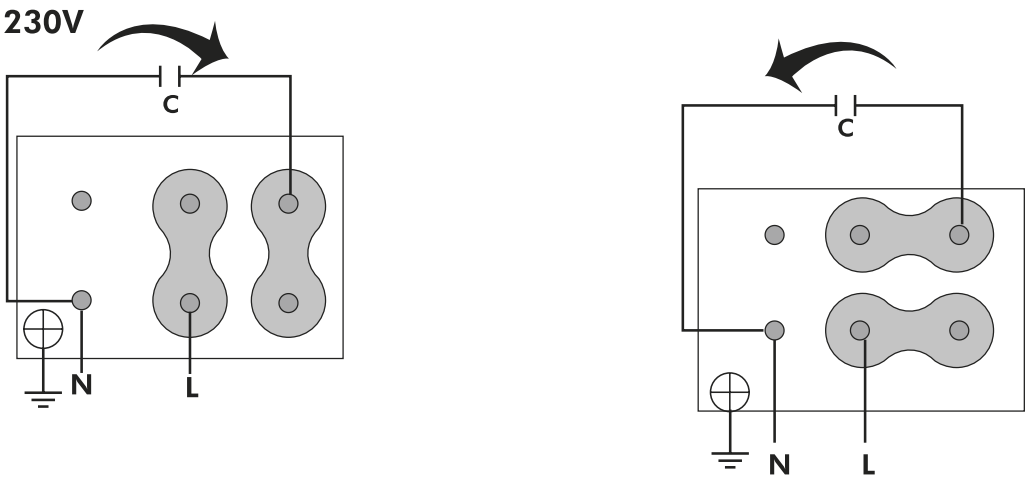

ACCESSORIES



**SAFETY SWITCH**  
**INT 25 3P A**  
**REF: INT253PA**



**STAINLESS STEEL INLET PROTECTION GUARD**  
**FOR CENTRIFUGAL FANS**  
**RAI 18/8**  
**REF: 300716902**



**ACOUSTIC CABINS FOR CENTRIFUGAL FANS**  
**AB (GENERIC)**

SPARE PARTS

	Code	Model	Qty
4	720301042	MOTOR 0,55kW M2 B5 230V	x1